



**CREATING FINE
MODEL HOBBY PRODUCTS
SINCE 1973**



**At the forefront of
modelling technology.
Looking after the modeller with
innovative and safer products**



Made in England

deluxematerials.com

Let's Model...



Creation & innovation of modelling products for over 45 years



We have always been interested in the chemistry of materials & how chemical structure influences both mechanical & physical properties. With a passion for modelling, we started a business to make better products for hobbyists.

As modellers, we can understand modellers' needs. As chemists we have the skills to create the best products.

At Deluxe Materials ... we are more than an adhesive company ... much, much more !

Vivienne & John Bristow



<p>The early years</p> <ul style="list-style-type: none"> • First 4 minute epoxy in large economical bottles - SPEED EPOXY 	1970's	<p>1980's</p> <ul style="list-style-type: none"> • First super-thin, odourless alternative to cyano (ca) - SUPER'PHATIC!
<p>SEARCH FOR SAFER & BETTER PRODUCTS</p> <ul style="list-style-type: none"> • Cleaner & safer finishing system alternatives to epoxy & dope - EZE-KOTE & EZE DOPE 	1990's	<p>2000's</p> <p>CLEVER SOLUTIONS TO TRICKY MODELLING PROBLEMS</p> <ul style="list-style-type: none"> • Micro dispensing of solvent plastic glue - PIN FLOW APPLICATOR
<ul style="list-style-type: none"> • Electrical conductivity enhancement of model railway operation - TRACK MAGIC 	2012	<p>2013</p> <p>ENVIRONMENTALLY FRIENDLY PERFORMANCE</p> <ul style="list-style-type: none"> • The world's first 2 stroke oil with heat protection for model gasoline engines, approved by top engine makers - POWER MODEL 2T-S
<ul style="list-style-type: none"> • Easy bonding of railway ballast - BALLAST MAGIC & a water spray • Safe & rapid paint removal from paint & airbrushes indoors - BRUSH MAGIC 	2014	<p>2017/18</p> <ul style="list-style-type: none"> • First low odour adhesives. Allow indoor working - PLASTIC MAGIC & PLASTIC MAGIC 10 SEC CEMENT <p><i>Low evaporation Minimal odour</i></p>

An introduction to our products with Hints & Tips on bonding

Wood: Recommend **Speedbond AD10/11** & **Aliphatic Resin AD8/AD9**. **Speedbond** is designed to dry fast. **Aliphatic** to sand nicely on balsa & is water proof. If gap filling is required, then **Speed Epoxy AD65** is a better choice. Choose **Back Scene Glue AD61** if you want to release the glue later with hot water.

Plastics: Often difficult to identify. Try **Plastic Magic AD77** first but allow time for it to work or **Roket** glue eg for resin. Shiny plastics - polythene, vinyl require the primer **Tricky Stick AC17**.

Clear plastics: Avoid fogging on clear plastics use **Glue 'n' Glaze AD55** or **Roket Odourless AD46**. **Glue 'n' Glaze AD55** has water clean-up & gap fills. Normal cyano glue will fog plastic.

Foam: Like plastic, foam is often difficult to identify. EPS (known as, Styrofoam or Depron) is melted by **Roket** superglue hence we developed **Foam 2 Foam AD34**. **Roket Odourless AD46** is foam safe but may

	White, blue or pink foam, (known as Styrofoam & Depron)	EPO foam (most commonly used for model airplanes with semi-rigid & shiny surface)	EPP foam Typically softer than other foams
Suitable adhesive	Foam 2 Foam, Roket Odourless, Super'Phatic!	Roket ca (any) Fix 'N' Flex (gap filling for hard surfaces) see below Super'Phatic!	Foam 2 Foam, Roket ca primed with Tricky Stick AC17

require **Roket Blaster AD17 & AD59** (foam safe) accelerator. Foam model aeroplanes commonly employ EPO foam (ethylene polyolefin) which can use **Roket ca** glue. Always check on scrap first. **Super'Phatic! AD21** is excellent for some tasks e.g. securing **carbon fibre** or hinges to foam

Fix 'N' Flex AD78: For bonding servos, fixing stiffeners, tacking exposed electrical circuit board, sealing cable exits & plastic decals to foam.

Problem solving glues, bonding composites:

We have 3 types of high performance structural adhesives:

AeroT<ch AD63/4 Non runny, epoxy developed to bond formers into composites, delivered ready mixed to the joint.	Super Crylic! AD23 Flexible, thin, laminate with glass cloth to bond dissimilar materials, epoxy, polyester & plastics.	Fusion AD19 Hard & tough, high strength, for high point stress applications on hard plastics, metals, composite & wood.
--	---	---

Looking after Super Glue: Here is a neat way of using ca glue to avoid clogging. First fit a **Roket Glue tip** & shorten if required. If the tip becomes blocked don't worry as this seals the bottle & preserves the ca.

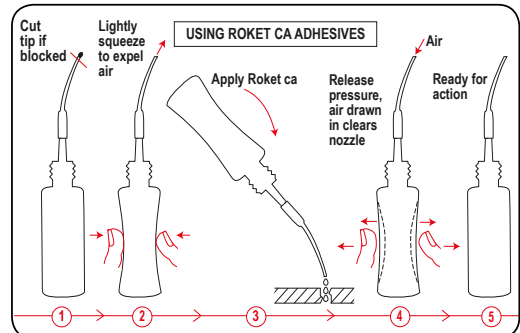

Looking after our products - Some practical storage advice

Keep cool and dry		Avoid freezing	Room temperature		
Cyano: Roket Hot, Rapid, Max & Odourless	Others Super Crylic Aerokote catalyst	Aliphatic Resin, Speedbond other water-based glues & finishing products: Eze Dope, Eze-Kote, Aqua Magic	Epoxy Glues	Plastic Magic Track Magic Roket Blaster	Other products Body Armour & Fix 'N' Flex
Away from light, heat & moisture. Ideal 8-14 C metal tin or metal foil bag. Best kept refrigerated. Allow to return to room temperature before use. Keep away from accelerators	Refrigerated 5-15 C. Keep caps tight	Normal room temperature 20 C. Avoid freezing	Room temperature. Crystallised (hard) epoxy can be re-liquefied without damage by warming in hot water to 60 C	Keep away from naked flames	Room temperature or lower. Replace cap tightly immediately after use

These symbols throughout this catalogue show the categories for which the products are recommended.



Thanks to Kinetic Model for the P-47D Razorback image.
Kinetic Model recommend Deluxe Materials.

ADHESIVES

Rocket cyano range

Highest quality cyanoacrylate, cyano (ca) adhesives

Designed for use with precise **Rocket Glue Tips** (AC20) and **Micro Tip** anti-clog applicator (AC9), both featured on page 4.

All sold as 20 g bottles/ 20 ml tube.



Rocket Hot

AD43

Super-thin, fast, penetrating adhesive; sets 1-5 seconds. Position parts closely together & apply one drop. **Bonds: wood, metal, rigid plastics (styrene, PVC etc.)**

Foam safe bond on EPO, EPP.

Rocket Hot is the perfect glue for penetrating tightly fitting joints. Store in a cool, dry, dark place.



*Here, the outer trailing edge of a balsa wing rib needed to be glued to a tiny notch in the wing trailing edge. A drop of **Rocket Hot** applied to the joint did the job in two seconds.*



Rocket Rapid

AD44

Medium viscosity, fast setting adhesive; sets 5-10 s. Apply to one surface & apply pressure holding parts together until joined. **Bonds: wood, metal, rigid plastics (styrene, PVC etc.)**

Foam safe bond on EPO, EPP. Store in a cool, dry, dark place

*A drop of **Rocket Rapid** applied to the joint did the job in five seconds.*



Rocket Max

AD45

Thick, maximum gap-filling adhesive; sets 10-20 seconds. Apply to one surface. Hold parts together until joined. **Bonds: wood, metal, rigid plastics (styrene, PVC etc.)**

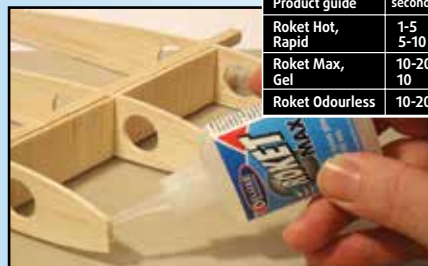

Product guide	Set Time/seconds	Penetrating for tight joints	Gap filling	Non drip	Non fogging on clear plastic	Bonds wood, metal rigid plastics (styrene PVC etc.)	Foam safe bond on:			Bonds shiny plastic with Tricky Stick
Rocket Hot, Rapid	1-5 5-10	Hot	No	No	No	Yes	No	Yes	Yes	Yes
Rocket Max, Gel	10-20 10	No	Yes	Yes	No	Yes	No	Yes	Yes	Yes
Rocket Odourless	10-20	No	No	No	Yes	Yes	Yes	Yes	Yes	Yes

Foam safe bond on EPO, EPP. Use to make strengthening fillets. For large areas apply small beads of glue at intervals & apply pressure to joint.



Rocket Odourless

AD46

Foam-safe, non-fogging, crystal clear, odourless grade. For bonding crystal clear plastics & foam; sets 10-20 seconds. **Bonds: wood, metal, rigid plastics (styrene, PVC etc.)**

Foam safe bond on EPS, EPO, EPP. Try this Odourless grade if you experience an allergic reaction to standard grades of ca.



Rocket Cyano Glue Gel **AD69**

Fast 10 second bond. A high strength cyano glue that does not run & is ideal for gap filling. **Bonds: wood, plastic, metal, card, rubber etc.** *The metal tube extends shelf life.*



Useful products for use with the Rokat cyano range

Tricky Stick



AC17 50 ml



Allows cyano to bond **DIFFICULT** plastics, rubber & foam including polypropylene, nylon, vinyl & silicone rubber. Increases the versatility of cyano as a glue & improves adhesive strength.

Fig 1. Simply brush **Tricky Stick** onto surfaces. Wait for it to dry & apply cyano. Incredible strength allows immense pressure to be applied as shown

Fig 2. **Tricky Stick** will enable cyano to bond difficult vinyl parts such as tank tracks

Fig 3. Finished model with clean, strong, joints.

Tricky Stick surface primer enables Rokat ca glue to spread & bond shiny surfaces

UNTREATED

TREATED

CA



Strengthens EPP foam joints

Rokat Blaster

AD17 50 ml spray bottle
AD59 250 ml top up bottle

Cyano accelerator spray which permits **Rokat ca** (AD43-46) to bond difficult surfaces & accelerate the cure. Pre-condition surfaces with **Rokat Blaster**. Once dry apply **Rokat ca** (AD43-46) for an instant bond to: wood, metal, rigid plastics (styrene, PVC etc.)

FOAM SAFE

Forces cure through cyano glue to fill gaps & enable fillets.

Glue Buster

AD48 28 g

Debonder & dissolver of superglue. Releases bonded skin & removes superglue stains. Stays on site for faster de-bonding action.

Rokat Powder

AD18 40 g

Strengthening powder for use with thin cyano adhesives to improve gap filling & toughness. Flows like liquid into spaces to take exact shape. Use for filling gaps where strength is needed. Sets in seconds with **Rokat Hot** (AD43) or **Rokat Rapid** (AD44) cyano; can be filed, drilled & tapped.

Rokat Glue Tips

Pack of six tips for precision, fine glue lines. Instant fit - Anti clog - No mess.

Fit Tip

Shorten as required

Stretch for finer application

One piece glue tips for the accurate application of Deluxe Materials glues:

Rokat cyano, Rokat Card, Super'Phatic! & Ballast Bond. Tips can be shortened or stretched for finer application.

Micro Tips & Tube

AC9

Pack of six **Micro Tips** & PTFE tubing for precise anti-clog application of **Rokat ca** glues (AD43-46).

Rokat Re-cap

AC16

Replacement caps for **Rokat** superglue, Super'Phatic! & Rokat Card Glue. **Rokat Re-cap** re caps, refreshes & restores your bottle.

Pack contains:

Rokat ca spout & cap x 2
Super'Phatic!/Rokat Card Glue cap x 1
Spare Micro Tip x 1

The best glue accessory ever!

ADHESIVES

Speed Epoxy II range



Speed Epoxy II
4 min AD65 224 g

Speed Epoxy II
4 min AD66 71 g

Speed Epoxy II 4 min
AD67 28 g twin tube

4 minute range
Speed Epoxy II
Fast setting
Sets Hard
Non brittle

Speed Epoxy II
4 min AD73 28 g syringe

A range of high strength, rapid setting, epoxy glues that are formulated to set hard, clear & sandable & tolerate mixing ratio errors. Packed in protective boxes. Each bottle has a 'witches hat' design free flowing nozzle with coloured over-cap.



Available in 4, 20 & 60 minute setting times in a selected range of sizes: 224 g, 71 g & 28 g

Speed Epoxy II
20 minute.
Increased working time & strength.
For tail fin & tail plane alignment

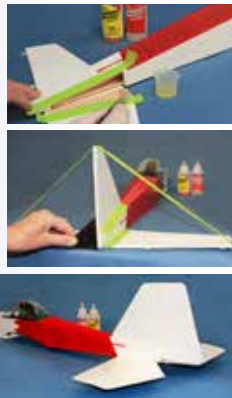

Speed Epoxy II
60 minute.
Maximum strength
For wing joining



Speed Epoxy II 20min AD68 224g

Speed Epoxy II 60min AD71 224g

AERO T<CH range

Specially formulated epoxy for bonding composite mouldings

AERO T<CH Epoxy Syringe AD63 25 ml



Non-drip, strong visible joints, 24 hour set. Syringe dispenses epoxy resin & hardener in equal parts & needs to be mixed thoroughly. **AERO T<CH** fills gaps & forms visible fillets for the highest possible joint strength. Ideal for formers, engine & undercarriage mounts, servo mounts & bulkheads. Bonds: epoxy GRP, carbon fibre, aluminium alloy, ply & hardwood etc. 25 ml twin syringe.



Recommended by:



AERO T<CH & hardwood



AERO T<CH & epoxy glass

AERO T<CH Epoxy Cartridge AD64 50 ml

Formulated epoxy for bonding composite mouldings. Non-drip. Use with **AERO T<CH** dispenser gun & mixing nozzle. Ideal for formers, engine & undercarriage mounts, servo mounts & bulkheads. Gels in 3-4 hours, full cure in 24 hours. Mixed adhesive may be stored in a freezer for 1-2 hours & re-used. **AERO T<CH** epoxy bonds: epoxy GRP, carbon fibre, aluminium alloy, ply & hardwood etc. 50 ml cartridge for use in **AERO T<CH** dispenser.

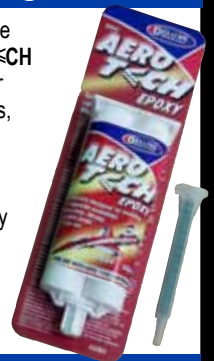

AERO T<CH Epoxy Dispenser AC15



Dispenser for AERO T<CH cartridge & nozzles.

AERO T<CH Auto Mix Nozzles AC14

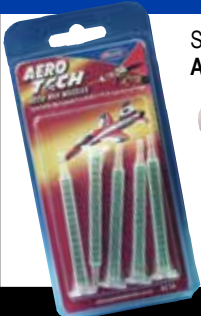

Specially designed mixing nozzles for **AERO T<CH** cartridge. Pack of 5 mixing nozzles for use with **AERO T<CH** epoxy syringe ensuring thorough mixing & maximum strength.

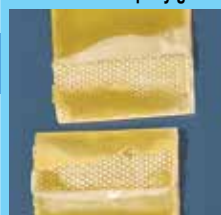

Tensile tests prove **AERO T<CH** is stronger than the hardwood & epoxy glass it bonds

Super'Phatic!



AD21 50 ml



The thin, non-fuming alternative to cyano.

- Low odour, water clean up
- Penetrates much further than other glues
- Provides non-brittle joints on balsa, ply, GRP, plastic hinges, foam & carbon fibre



Recommended by: retrorc.us.com



Excellent glue for brass photo etch

Speedbond



AD10 112 g and AD11 500 g



Special modelling PVA glue that contains no fillers. Has unique solvent chemistry for faster drying & is superior to many DIY PVA glues. Bonds wood, foam, fabric, paper.

Recommended by:



Fusion



AD19 75 ml



Perfect mixing consistency

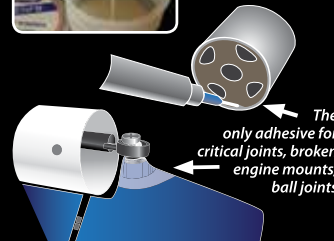

The only adhesive for critical joints, broken engine mounts, ball joints

Strongest acrylic adhesive for combinations of GRP, metal & wood & nearly all plastics such as ABS, PVC, styrene, acetate, acrylic. The only choice for bonding & repairing critical highly stressed parts such as motor mounts, lugs, bulkheads, metal fasteners onto polyester, epoxy or carbon fibre.

R/C Modellers Canopy Glue



AD81 80 ml



Multi-purpose gap-filling canopy glue. Thick & tacky, dries clear, remains flexible. Bonds combinations of wood, plastic, fabric, foil, painted surfaces. Ideal for:

- Aeroplane canopies
- Model boat plastic windows
- Sealing gaps & small holes
- Repairing tears in covering film
- Application of rivets on scale models.

Fine nozzle

Same glue - NEW better tube!

Cover Grip



AD22 150 ml



Heat sensitive adhesive for increasing the adhesion of plastic covering films (even aluminium foil) & trim to balsa & ply surfaces. Ideal for vulnerable areas eg. engine bays.



Tissue Paste



AD60 50 ml



Clear drying paste for bonding tissue paper used on traditional model aeroplanes. The formulation allows delicate tissue paper to be placed onto airframes & smoothed without tearing.

Recommended by:



Aliphatic Resin



AD8 112 g AD9 500 g



Famous "yellow" wood glue used in aeromodelling & professional applications where hard woods are used; dries crisper than PVA giving better sanding especially with balsawood. Will not pull joints as it sets, resulting in better dimensional stability important for airframe construction.

Also sets at low temperatures & is water resistant making it ideal for model boats. Use in miniature furniture making where its useful properties include:

- Taking a stain
- Faster grab time



Recommended by:



Super Crylic!



AD23 60 g



Tough, problem solving adhesive for models where high impact plastics (eg. ABS) need to be bonded to wood, metal & GRP etc.



Ideal for:

- Wooden engine bearers
- Plastic cowling repairs. Low viscosity allows use with light glass cloth. Ideal where epoxy or cyano does not work.
- Model boat: Fixing propshafts & rudders inside boat hulls
- Repairs to plastic hulls.

60 g twin pack

Foam 2 Foam



AD34 50 ml



FOAM SAFE



For rapid foam modelling. Very high-tack glue. Strong hold, allows adjustment. Dries clear & flexible. Ideal for foam model aircraft. Bonds: Depron, white, blue & EPO foams, wood & plastic. Also an excellent fabric glue.

ADHESIVES



Fix 'N' Flex



AD78 40 ml

Clear, tough, resilient, gap-filling adhesive. Bonds foam, plastic & metal. Produces flexible bonds in ways that other glues cannot.

A one part, clear, air drying & odourless adhesive with exceptional surface grip setting at 1-2 mm /hour. Joints that are both waterproof & heatproof. It is especially effective where joints need to:

- Flex, expand, gap fill without shrinkage
- Be non-corrosive or aggressive to paints, plastics or electrical circuit boards
- Withstand high & cold temperatures
- Be non-shrinking & painted

Its uses are many & include:

- Securing model railway track, street furniture, buildings & trees
- Foam models -construction & repairs
- Secure servo trays & motor mounts into foam
- Bonding plastic or carbon fibre stiffeners into foam
- Securing plugs, repairing broken leads & cables



Ideal for street furniture

Fix 'N' Flex AD78 supplied in a 40ml tube with a small purpose made dispensing nozzle.

Excess adhesive can be removed with white spirit.



Body Armour



A highly flexible polymer adhesive specially designed for re-inforcing & repairing plastic model car bodies.

Impact resistant & safe on paint. Bonds to most car body plastics, metal, including polycarbonate & styrene & will not attack common model car paints.

Body Armour can also be used to attach electronics, wires, LED light bulbs.

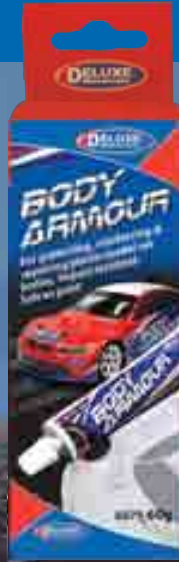

AD79 60 g



Remove cap & apply to critical areas. Smooth & contour with a damp finger.

Sticky Mat Adhesive



AD80 50 ml

For holding, precise cutting & sanding of thin sheet paper plastic & brass metal etc.

Ideal for:

- model trim & decal fabrication
- paper & stencil cutting
- holding brass etch for cutting
- display mount board
- plan tiling & appliqué
- sanding flat small objects

Dries in 5-7 minutes leaving a tacky surface that will only

require periodic re-coating.

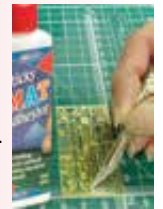

Dolls House Tacky Glue



AD27 112 g



Very sticky glue which dries clear, flexible & is non-staining. Use for:

- bonding fabric
- plastic windows
- flower making
- bonding ceramic or flexible tiles

Superior to other tacky glues in that it dries clear & bonds plastics, varnish & paint.



Wallpaper Paste



AD32 250 ml



Ready-mixed paste that dries clear. It is non-staining & does not attack copper wires or tape.



Decorator Glue



AD26 112 g



Thick glue, which, like Tacky Glue dries clear overnight. It has instant stronger hold round corners & on vertical surfaces whilst also allowing re-positioning.

Bonds fabric, leather, silk, paper, wood, glass, plastic, metal, painted & varnished surfaces.



Tacky Wax



AD29 28 g



Wax adhesive for holding miniatures in place whilst allowing re-positioning.

Many other uses eg. carrying small screws.



ADHESIVES for plastics

Plastic Magic
1 second cement



AD77 40 ml



BONDS PLASTICS OTHER GLUES CANNOT

Deluxe Materials **Plastic Magic** is a liquid solvent glue that produces **invisible glue lines**. The new safer formula can be applied with the Deluxe Materials **Pin Flow** solvent glue applicator (AC11) or conventionally with a fine paint brush. **Plastic Magic** bonds nearly all commonly used modelling plastics including polyester, acrylic, styrene, ABS, PVC, butyrate, & polycarbonate.

	Polyester	Styrene	ABS	Acrylic	PVC	Butyrate	Polycarbonate
	✓	✓	✓	✓	Poor	✓	✓



1 second bond



'1/100 Gundam Astry Red Frame Low Gule' made by Jose Brito seen below working with AD77 & AD83



Plastic Magic
10 Sec Cement AD83 40 ml



SAFER TO USE
INDOORS

10s



10-15 second adjustment time

A thin liquid plastic cement with an extended **10-15 second bond time**. It is applied to one or both surfaces & allows time for adjustment to a perfect position. **Non-toxic, non-flammable** with **minimal odour** & almost **zero evaporative loss**.

It bonds: styrene, plastic card, ABS & most kit plastics & is packed in a stable bottle with a choice of 2 brushes that deliver:

- high precision & long reach
- the tiniest drop
- access to the last drop in the bottle.

Plastic Magic 10 Sec Cement will not harden applicator brushes & tips require no cleaning.

Choose **Plastic Magic 10 Sec Cement** when you need:

- an almost odourless plastic glue
- 10-15 seconds working time
- to bond large areas or long lengths
- to adjust parts
- to bond common kit plastics, ABS, styrene.



PLASTIC GLUE SELECTOR

Brand of glue	Adhesive Performance								Bonds ABS, Styrene, Plastic card, Butyrate
	Set Time / Secs	Invisible glue line	Adjustable joint as it sets	Sets clear	Gap filling ability	For clear glazing	Water clean up		
Plastic Magic 10 sec	10-15	Yes	Yes	Yes	No	Yes	N/A	Yes	
Plastic Magic	1-5	Yes	No	Yes	No	Yes	N/A	Yes	
Roket Plastic Glue	10	Yes	Yes	Yes	No	Yes	Yes	Yes	
Plastic Kit Glue	5-10	No	Yes	Yes	Yes	No	N/A	Yes	
Roket Hot, Roket Max	1-20	No	No	Yes	Yes (Max)	No	N/A	Yes	
Roket Odourless	10-20	Yes	No	Yes	Yes	Yes	N/A	Yes	
Glue 'n' Glaze	60 mins	Yes	Yes	Yes	Yes	Best	Yes	Yes	

Roket Plastic Glue



AD62 30 ml



Liquid plastic cement. Non-toxic, non-flammable, low odour & fine non-clog tip that gives invisible glue lines. Can also be applied with brush, or

Micro Tips & Tube (AC9). Bonds in 8-10 seconds & builds strength. Bonds: styrene, polyester, butyrate & plastic card. Water washable.



Plastic Kit Glue



AD70 20 ml



A very fast, plastic cement for all types of plastic kits. The clog-resistant formula & fine tip bottle make for great ease of use.

Bonds: styrene, clear plastic & even wood to plastic.



Ballast Magic



AD74 125 ml



Innovative powder adhesive

For clean, easy bonding of scatter & ballast. Instant grab, adjustable bond, reversible joints. A new way to ballast track in all scales especially for fine point work. The adhesive itself is a fine dry powder that is very easy to mix in with ballast. Bond is reversible with warm water.

- Fast drying 1-2 hours
- Safe to use
- Good bond resistant to everyday handling
- Can be manipulated easily & mixed with most scatters
- Ideal for large areas, fixing coal, creating piles of debris etc.



Most granular ballast to water	7 to 1
Nut based ballast to water	4 to 1

Ballast Magic 125ml covers up to for 20 metres of 00 gauge track



Ballast Magic Kit



AD76



Kit contains

Ballast Magic (125 ml), fine misting spray bottle & handy mixing accessories. A new innovative product for ballasting track. It will not harden cork & is especially useful when ballasting around points as it can be applied in a controlled manner without the risk of a liquid adhesive flowing into the working parts of a point. This adhesive is very versatile & can also be used to fix down scatter materials, piles of coal. Can be removed with warm water if you wish to re-position track.



Glue 'n' Glaze



AD55 50 ml



For glazing & bonding crystal clear windows & canopies. A liquid plastic film-forming polymer which bonds most plastics & dries to a crystal clear film. It is ideal for miniature windows (00 gauge) or up to 6mm across. It will not smear or fog clear plastics. Ideal for scale aircraft, plastic canopies & glazing dolls house windows. Easy water clean up.



Ballast Bond



AD75 100 ml



Liquid adhesive

for easy bonding of railway ballast scatters. Ready to use. Rapid spreading. Clear matt finish. Super thin, ready mixed adhesive for bonding railroad ballast, coal & other granular materials used in scale landscape modelling.

Low viscosity & capillary action ensures efficient spreading & fast drying.



Rocket Glue Tips (AC20) perfect for fine application of Ballast Bond.

Instant wetting and spreading action

Coverage of the 100 ml Ballast Bond pack

Quality ballast grade(s)	100ml coverage
Fine	0.5 yd ² (0.4 m ²)
Coarse	0.3 yd ² (0.25 m ²)
Length of 00 gauge track	10 yds (9 metres)

- Instant wetting
- Does not disturb the ballast
- Safe to use
- Efficient for large areas, fixing coal, creating piles etc
- Non-greening & biocide protected

Backscene Adhesive



AD61 225 ml



Backscene adhesive

is for bonding model rail/diorama backscene papers to hardwood, hardboard, painted surfaces, plaster, plastic coated & plaster board. It allows easy positioning & adjustment.

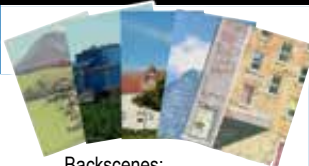

Backscenes: Peco, Faller, Gaugemaster, Vollmer, Walther

225 ml coverage approx 6 sq m² (65 ft²)
6 back scenes

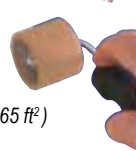

Scatter Grip



AD25 150 ml



Special adhesive which dries tacky allowing plenty of working time for bonding 'static grass' & scatter materials. Ideal for railway layouts, scenery, dolls house gardens.

150 ml coverage approx 1 sq m²



Rocket Card Glue



AD57 50 ml



For fast assembly of card models e.g. railway buildings & rockets. Also bonds balsa wood, paper & card to most plastics. **Use sparingly**, align & press parts together for instant bond. Water clean up. See article page 17

Recommended by:



www.metcalfemodels.com



www.superquick.co.uk

Scenic Spray Glue



AD54 100 ml



Spray glue for the attachment of scenic materials, e.g. scatter to trees or baseboards etc. Non-staining. Dries clear & tacky. Gentle spray action.



SCENICS

Create and Shape



BD60 240 ml



Casting a rock face



A lightweight, non-sagging scenic modelling material for the creation & casting of realistic diorama groundwork. **Create and Shape** can be moulded & smoothed with a soft wet brush before it is completely dry.

It dries without cracking to a material with great structural integrity, bonding wood, plaster, plastic, foam etc. It can be cut, sawn & filed to shape when dry without crumbling like other products & then glued & coloured with acrylic paints for beautiful scenic effects. Ideal for repairs & special scenic projects where strength & durability is required.

240 ml pack

Creating mud effects



Scenic Rust



RUST

BD27 100g Combined



Creates a realistic texture & scale rust finish onto all types of paintable surfaces, wood, plastic, metal.

It works within hours thereby creating greater realism for all types of modelling.

Scenic Water



BD43 125 ml



A re-meltable one part resin that pours, flows & sets as you want it. Best suited for small liquid projects e.g. simulating drinks & many food items incl. jams particularly in enclosed containers. Melts at around 60C (140F). Avoid direct contact with metals - pre-treat with lacquer.

Scenic Colours BD23
Red, blue, yellow, black & white dyes for easy of colouring **Scenic Water**

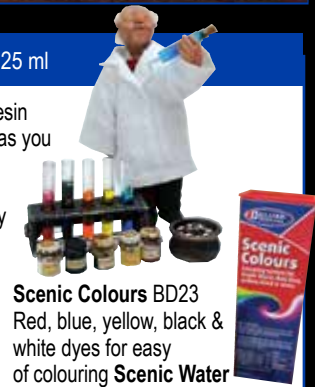

Scenic Snowflakes



BD25 500 ml



For the creation of dramatic snow scenes in minutes. Allows you to create easily real snow effects such as newly fallen, melted, slipped & frozen, on houses, trees & vegetation.

Scenic Snowflakes are different from other snow because they allow you to add the detailed snow effects that will distinguish your work from other common 'picture postcard' winter scenes. Coverage up to 1.5 m² 500 ml shaker pack.

Scenic Shovelled Snow



BD26 500 ml



A unique type of snowflake developed for creating special snow effects. Ideal for piled snow along with snowballs & snowmen which are not possible with other types of snow. Mix with **Scenic Spray** glue or **Scatter Grip** & mould to shape. May be used on plastic, resin, metals etc.



Scenic Snow Kit



BD29

For dramatic winter snow effects



Complete kit containing high brightness **Snowflakes** (approx 100 ml), **Snow Bond** adhesive & **Icy Sparkles**. Snow covers 0.5 m². (Icy Sparkles available separately BD33).

Scenic Fibres



BD28



0.5 metre pack. **Scenic Fibres** work with **Making Waves** to allow easier, faster & more realistic modelling of moving & white water e.g. waterfalls, rivers. Forms a base onto which **Making Waves** can even be brushed down vertical surfaces in waterfalls.



Making Waves



BD39 100 ml



For creating waves, ripples, waterfalls & moving water effects. **Making Waves** is a one part, clear setting, water based, low odour resin that holds its shape, even on vertical surfaces. It may be used to:

- Make shallow water effects eg. streams, puddles
- Texture **Solid Water** surfaces with ripples & waves
- Texture **Scenic Fibres** for waterfalls



Solid Water

BD35 90 ml BD36 350 ml



Low odour, non-shrinking 2 part resin for simulating bubble free crystal clear water for miniature bowls, garden ponds, canals, lakes & puddles. Creates the illusion of deep water even with minimal thickness. Use it for still water (canals or lakes) in railway layouts. Texture surface with **Making Waves** (BD39).

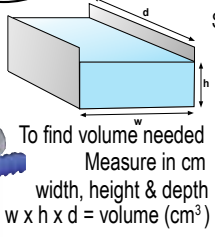

Setting characteristics at 23 C (73 F)

Time / hours	Condition
0	Fluid
3.5	Not mobile (gelled)
5.5	Tack free surface
8.5	Hard
18	Fully cured

Tip: Mix 90 ml max at a time.



Coverage at approx 2 mm deep

Mixed quantity	m ²	(cm ²)	in ²
90 ml	0.045	(450)	70
350 ml	0.175	(1750)	271

Aqua Magic

BD64 250 ml BD65 125 ml



One part solution to the scale modelling of water effects such as rivers, canals, lakes, ponds, puddles & mud. It requires no mixing, is easy to pour & rapidly dries crystal clear in 36-48 hours to an impressive light stable, highly reflective, gloss finish. Can be coloured with water-based dyes & paints & textured as it dries. Increase depth by adding layers. **Aqua Magic** is used for water where the surface is exposed to air for drying. Not suitable for very deep water or enclosed water applications e.g. drinks & goldfish bowls.

- Highly realistic reflective finish
- Light stable
- Pour in thin layers up to 3 mm
- Can be textured
- Touch dry in 5.5 hours
- Non-toxic & low odour

Covered area at 3 mm depth		
	BD64 250 ml	BD65 125 ml
cm ²	750	375
in ²	116	58

'Highly reflective'

Tips (on using Aqua Magic)

- 1. Level your scene.** Check that the baseboard is level & fully dry e.g. after damp ballasting.
- 2. If used on unknown riverbed materials & paints,** pre-test Aqua Magic on scrap or inconspicuous area before committing to your scene. Enamel & oil based paints are also safe.
- 3. Drying characteristics & building depth.** Initial, slightly milky layers turn clear when dry. Allow 2 days to dry before applying multiple layers, longer in damp weather. Do not use a finger to test if the water is dry. You may leave a fingerprint!
- 4. Storing the product for long life.** Close container after use & store above 0C.
- 5. Adding Colour.** Always test Aqua Magic film drying quality when mixing with colourants (dyes & acrylic paint). Deluxe Materials' Scenic Colours BD23 work well.



useful modelling ACCESSORIES

Track Magic

AC13 50 ml

Track Magic is a special cleaning fluid for model rail & car tracks, electric contacts & wheels.

- Improves conductivity for a smoother running performance
- Works in low power/confined space situations
- Revives old electric contacts & improves new ones
- Long term protection to reduce maintenance
- Leaves no oily residues

Keeps your train running more smoothly for longer!

Apply Track Magic using a soaked swab or supplied sponge or in tricky confined areas with the fine brush applicator supplied. Suitable for track cleaning vehicles.



Track Magic cleans by dissolving microscopic oily contaminants. It evaporates completely leaving a dry, protective, conducting, invisible film & reduces the need for further track maintenance

Track Magic should only be used on conductive parts. Take care when applying, mopping up any excess if spilled onto plastic parts

Rail track samples after 2 weeks immersion in salt water



Untreated with Track Magic Treated with Track Magic



Track Magic Accessory Pack AC18. Specially developed kit of 3 swabs & one micro brush for easy application of Track Magic.



Living Steam

AC21 90 ml

Scent & smoke oil - For creating authentic steam railway scent or scented smoke. Living Steam a uniquely designed, safe, non-flammable fluid for the generation of realistic, nostalgic odour of steam railways. Living Steam can be used in 2 ways:

- 1.** Place on absorbent material & position in the room & allow to evaporate.
- 2.** Or it can be used as a smoke oil (eg. from model rail smoke generators) creating additional odour.

Living Steam is non-flammable making it probably unique in the market place.



Smart Plastic

BD63 125 g

Heat mouldable modelling plastic. Melt & then mould in your hand. A safe, white modelling plastic that is easily melted in hot water (40-60 C / 100-140 F) to a soft consistency, ideal for hand moulding to any shape. Smart Plastic sets in 3-4 minutes to a tough, flexible plastic that can be re-melted.



It is highly versatile in use & ideal for: custom fabrication, impressions, masks, moulding, prototypes, design, craft, repairs, strengthening & filling plastics & other materials.

- Quickly cools to handle
- Can be coloured with inks or acrylic paint
- Setting is accelerated by cold water
- Cut with metal cake cutters or scissors

useful modelling ACCESSORIES

Brush Magic AC19 125ml

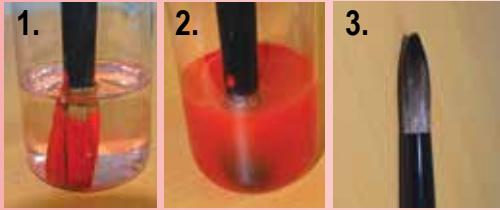

Brush Magic is a powerful, non-flammable brush cleaner for the rapid cleaning of all types of wet or dried paints from brushes.

- Washes away with water to a clean, non-oily surface
- Non-volatile & low odour
- Dissolves acrylic, enamel & cellulose paints
- Dissolves epoxy & polyester resins before they are set

If decanting, use only glass or polythene containers.



Brush Magic has been tested with: all types of modelling enamel & acrylic paint lacquers, all types of brushes: sable, nylon etc., & most types of airbrushes with Teflon or O-ring seals.

Tip: Use to remove wet or dry PVA from wood for perfect staining.



Pin Flow - Solvent Glue Dispenser AC11



An applicator specially designed for the precise control of liquid solvent plastic adhesives such as **Plastic Magic (AD77)** & **Plastic Magic 10 Sec Cement (AD83)**.



When even a brush can sometimes deliver too much, this breakthrough device will deliver just the right amount of adhesive to bond the most intricate parts. Prevents glue runs. Creates invisible joints especially on clear plastic.

Spare needles available from www.deluxematerials.com

Strip Magic AC22 125 ml



A fast acting, spreadable & controllable paint stripper that will soften & remove paints & primers, in typically 5-15mins according to paint type.

- Softens & removes paint from plastic in minutes
- Works on acrylic, enamel, cellulose & oil
- Stays where it is applied
- May be used on plastic, resin, metals etc
- Non-corrosive, non-flammable
- Removes decals & lettering

Clean up with methylated spirits or rubbing alcohol.



Pin Point Glue Syringe Kit AC8



Pack of 2 dispensing syringes & 3 sizes of stainless steel needles for accurate application of water based glues: **R/C Modellers Canopy Glue (AD12)**, **Speed Bond (AD10)**, **Aliphatic Resin (AD8)**, **Tacky Glue (AD27)**, **Decorator Glue (AD26)**.

Easy to clean syringes & tips using warm soapy water. Stop tips clogging by resting on damp sponge or in water.

Plastic Magic Glue brush AC25



Pack of 3 brushes for the application of **Plastic Magic (AD77)** & **Plastic Magic 10 Sec Cement (AD83)** to small scale tiny parts. The superfine, long reach brushes will deliver the tiniest drop of solvent adhesive even to difficult joints.

- High precision
- Long reach for tight places
- Enables clean glue action
- Delivers tiniest drop
- Reaches last drop



Pin Point Bottle Kit AC10



For precision gluing. A small soft dispensing bottle ideal for minute application of water based glues such as **R/C Modellers Glue (AD 12)**, PVA glue & fluxes. Ideal for many tasks where fine, finger controlled gluing action is needed.

It is supplied with a variety of three plastic & metal tips that are easily cleaned with water after use.



LUBRICANT



PowerModel 2T-S LU01 500 ml

Fully synthetic model gasoline engine 2 stroke oil. High temperature protection. Accurate & easy mixing. A unique, full synthetic, high detergent 2 stroke oil. It works at all recommended ratios for 2 stroke gasoline air & water-cooled engines used in model aircraft, cars & boats. It can also be used in 4 stroke engines when the manufacturer recommends a good quality 2 stroke oil. For diesels too!

- Safer running at high temperature
- Maximum resistance to seizure & wear in extreme conditions
- Cleaner exhaust emissions
- Outstanding tickover stability & throttle response
- Outstanding piston & cleanliness
- Attractive odour
- Protection while the engine is switched off
- Outstanding fresh & saltwater corrosion protection

Suitable for : Desert Aircraft, OS, Evolution, DLE, Great Power Model Engines, Saito, Zenoah, MVVS, NGH, DLA, MOKI, PAW, ZDZ, 3W & BME engines at manufacturers recommended ratios.

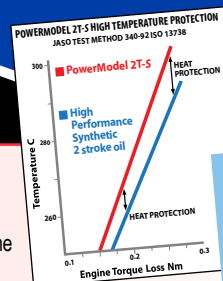

7 official engine maker approvals! Includes famous engine makers OS, Saito, RCGF, DLE, Evolution, Chung Yang, NGH



FINISHING PRODUCTS

Carbon Fibre Tissue BD62

Weight: 10 g / m² (0.3 oz / yd²). Specially developed carbon fabric for surfacing & strengthening lightweight materials such as balsa, ply & foam. It is rapidly bonded using thin glues such as **Roket Hot** (AD43), or laminating resins eg. **Eze-Kote** (BD37), **Eze Dope** (BD42) & **Aeropoxy** (BD1). It is not designed for tissue covering of models.

Uses include:

- Reinforcing undercarriage mounts
- Wing joining
- Servo trays
- Propeller blades
- Foam surfacing

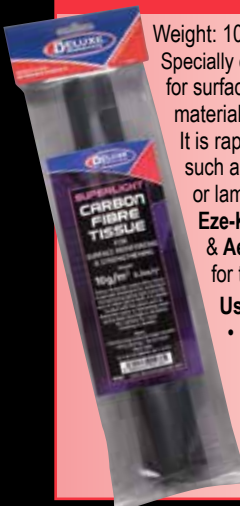

Aerokote Gloss & Catalyst BD45 150 ml Spare Aerokote Catalyst available as BD47 15 ml

Tough, high gloss, 2 pack, fuel resistant lacquer. For brush or spray application. Touch dry in 5 -10 minutes for dust free finish. Of all the finishes you can apply **Aerokote** is the ultimate.

Aerokote Gloss pack comes as 150 ml lacquer & 15 ml catalyst. Coverage approx. 1 m² of hardwood (less for more porous balsa). The correct ratio 10 : 1 Aerokote : Catalyst. Mix well. The ratio should be adhered to. Adding more catalyst does not make it set more quickly. Using less will mean that it does not fully set.



Resistant to hot alcohol, gasoline or kerosene containing high nitromethane & mineral, castor, synthetic ester, or poly-glycol synthetic oils.

Tip: Always test on scrap material with the same surface before application. Ensure surfaces are clean, dry & that any paint is fully hardened especially when applying by brush. Best applied with an airbrush using a light dusting coat, allowed to dry (min 4hours) followed by further coats to build the required finish.



Important notes for Aerokote Gloss/Matt: Always check on scrap painted pieces before applying. Do not store mixed Aerokote for use for more than 24 hours. Enamel paints caution: Allow enamels a minimum of 2 to 3 days to dry fully as Aerokote may cause softening, blistering if not fully dry.

Aerokote Make it Matt BD61 50 ml

Converts **Aerokote Gloss** to satin or matt finish. A simple matting agent that blends readily with **Aerokote Gloss** to give it a satin or matt finish. Just measure & add "**Make it Matt**" to **Aerokote Gloss** in the quantities as tabulated below & then add **Aerokote Catalyst** to the mix in ratio 10:1 as usual & mix well.



Finish required	Gloss	Satin effect	Matt	Dead Matt
Volume of Make it Matt to add to 25 ml of Aerokote Gloss	nil	8 ml	16 ml	25 ml

Eze-Kote BD37 500 ml

Laminating & finishing resin for balsa & foam models. **Eze-Kote** is a one part water based, foam-safe, low odour resin alternative to epoxy. Brush onto balsa & light glass cloth to create a tough, ding & fuel resistant film that can be sanded easily & painted after 20 - 30 minutes. Coverage: 500ml pack covers 6 m² of fabric



FINISHING PRODUCTS

Perfect Plastic Putty BD44 40 ml



Fills fine gaps. Creates invisible seams. Water clean up.

Perfect Plastic Putty is a one part, fast-drying, white, superfine filler with good adhesive & sanding properties on plastic. Easily used, even in awkward areas. Apply with small spatula, smooth & allow to dry.

Perfect Plastic Putty:

- Dries quickly without cracks to an ultra smooth finish
- Fills deep cavities & takes paint easily
- Low odour
- Ideal for texturing



Now packed in "NEW" aluminium tube



Colour with acrylic paint to simulate mud spatter



Eze Dope BD42 250 ml



A specially formulated, water soluble, dope for shrinking, strengthening & wind-proofing model tissue paper. It is non-flammable, has little odour & dries rapidly to a semi-matt fuel-proof finish.

Can be used to apply tissue decoration to all types of foam. When dry & cured the finish is totally fuel proof to both diesel & straight glo fuel.

Tip: When diluting use soft or distilled water. For instructions see article on page 17 'Doping the Eze Way'

Recommended by:



retorc.us.com



Solution
30% Eze Dope:70% water



Foam Armour BD50 250 g



- Creates a hard durable surface layer on foam & wood.
- Ideal for scenics, model aircraft etc.

A thick, water based resin that sets to produce an attractive, durable, scratch-resistant coating on foam to prevent dings, wear & disintegration. It dries to a surface that can be painted & glued easily & will reduce damage.

- Easy to apply
- Seals surfaces, gaps & foam edges to prevent disintegration
- Can be over-coated or mixed with acrylic paint
- Is easily glued and worked
- Bonds grass & scatter materials



250g pot covers 0.7 m² / 7 ft²

Aeropoxy BD1 300 g



300g pack covers approx 2m² using 34g/m² glass cloth



Super-thin epoxy for wing skinning, laminating and moulding. Use with lightweight glass cloth to add strength and toughness to models.

Model Lite BD5 White 240 ml BD6 Balsa 240 ml



Strong, lightweight filler which sands easily. Use only where a strong joint is not required. Use for grain filling by applying with plastic sponge. Bonds: wood, foam, fibreglass.

White or balsa tint.

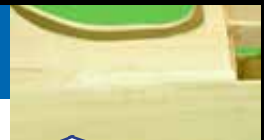

Use to blend in with natural finish or under clear covering film in aeromodelling.



WonderFill BD48 240 ml



The next generation of strong lightweight fillers for foam & wood. An easy sanding, strong, lightweight filler designed to fill small gaps & indentations.

Easily applied, smoothed, then sanded back. Does not crumble like other lightweight fillers & can be over-coated with Deluxe Materials **Foam Armour** (BD50) for improved surface toughness, & finish before being painted.



Sand 'n' Seal BD49 250 ml



A specially formulated wood grain sealer. Coats & seals wood grain prior to painting & finishing. Use with all types of paints including enamel, cellulose, acrylic or epoxy. Stir thoroughly before use. Apply with brush & allow to dry. Sands beautifully after 60 mins. Clean brushes with water. Economical in use. Low odour & non-flammable. Covers 1.5 m².



Epoxy Wing Joining Kit

BD10 50 ml



Laminating epoxy & lightweight glass cloth in kit form.



Kit provides sufficient quantity to join a set of wings.
Length 75 cm x 10 cm width

Micro Balloons

BD15 240 ml



Lightweight, free flowing, white powder which is mixed with polyester or epoxy resin to make an easy sanding strong filler. Can also be used to create snow effects (smaller than 1:48 scale) with **Scatter Grip** glue (AD25).

Close up of Microballoons mixed into Speed Epoxy



Liquid Gravity

BD38 240 g



A non-toxic, easy flowing, weighting system for scale military models, railway

rolling stock, model planes, boats & cars. Specially designed to pour into small cavities & set in place with your favourite **Rocket** cyano (AD43-46), or **Speed Epoxy II**. Use to improve appearance of dolls house curtains, cushions, bedspreads, adjust balance point of model planes, boats & submarines. 50ml bottle weighs almost 0.25 kilo!



Super Lightweight Fibreglass Cloth

For laminating. Unique fabric finish for better "wetting out" & strength. Use with **Eze-Kote** (BD37) or **Aeropoxy** (BD1).

Close up of Fibreglass cloth

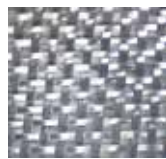

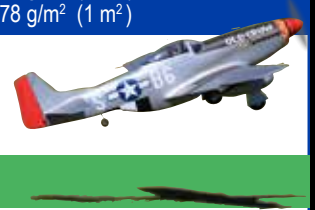

Apply Eze-Kote finishing resin to fibreglass for a smooth, durable finish

- BD11 24 g/m² (2 m²)
- BD12 34 g/m² (1 m²)
- BD13 51 g/m² (1 m²)
- BD14 78 g/m² (1 m²)



LET'S MODEL WE SHOW YOU HOW

Creating authentic rib stitching & rivets

 Gary Ritchie shows you how 

R/C Modellers Canopy Glue (AD81) & Pin Point Syringe Kit (AC8)

A novel method of simulating wing rib stitching & rivets employs the Deluxe Materials Pin Point Syringe Kit & R/C Modellers Canopy Glue



Fig 1. First, a syringe is filled with R/C Modellers Canopy Glue, right out of the tube.



Fig 2. Wing rib stitches are simulated with the smaller syringe tip, carefully running glue lines on predetermined marks across the wing rib caps.



3. Using the selected syringe needle tip, a drop of glue is applied to the front wing flap of this Tiger Moth to simulate a rivet.

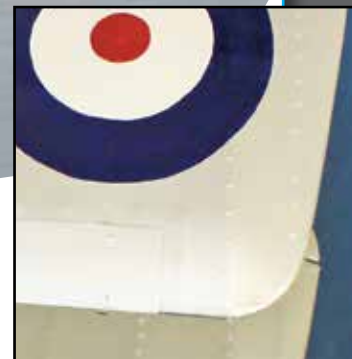

4. The Tiger Moth is painted & ready to fly.

Wing rib stitches 

Super'Phatic! glue... hinges too!

Super'Phatic! AD21 is a unique adhesive product that has so many uses including making the task of bonding hinges easier, bonding foam & even brass etc! Discover why it is superior to cyano & epoxy.

Fastening hinges to airplane control surfaces has always been challenging owing to the difficulty of gluing nylon to balsa without gumming up the hinge pins. Now there is a solution to this problem. Super'Phatic! glue by Deluxe Materials is easy to apply, provides simple water-based clean up & gives a tight, permanent bond between the balsa & the hinge material. It beats ca & two-part epoxy hands down.



1. Just apply a small bead of Super'Phatic! to your hinge & slide it into the wing. It will be dry & ready to go in only a few hours.

2. Water clean up of Super'Phatic! couldn't be easier.



3. It doesn't matter what type of hinge you use.



4. After an over-night cure, Super' Phatic! glue is stronger than wood.

Gary Ritchie shows you how

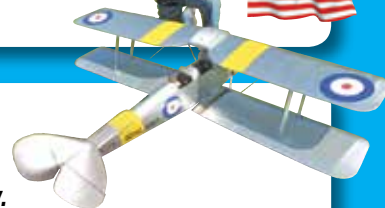

Fibreglassing floats with Eze-Kote

Your days of finshing with epoxy are over!

With Eze-Kote BD37 Gary Ritchie of Model Aviation Services USA shows you how.

For decades experienced R/C model airplane builders, especially scale builders, have relied on fibreglass & epoxy resin to create a tough finish on balsa wood that resists dings & scratches & will accept most paints. Well now this job can be done better & faster with Eze-Kote.

The benefits are:

It is safe, cleaner & non- sticky with no smell or waste

- Brushes can be cleaned with water
- It saves time - build & finish in a day!
- It easily wicks into cloth & rapidly dries
- It is effortless to sand & prime

Gary Ritchie noticed the floats covered with Solartex on his favourite Tiger Kitten model looked worse for wear so he decided to refurbish them using the simple Eze-Kote technique.



Fig 7. Finished & in the air!



Fig 1. All you will need is a bottle of Eze-Kote, a selection of Deluxe Super Lightweight Glass Laminating Fabric, a small cup & a paintbrush.



Fig 2. After an initial coat of Eze-Kote has been applied & allowed to dry, a piece of 0.6oz Glass Laminating Fabric is cut & laid on the surfaces.



Fig 3. Eze-Kote is then brushed through the glass fabric. The float in the background has already been covered.



Fig 4. After drying, excess fabric can be effortlessly trimmed away using 320 grit sand paper.



Fig 5. Both floats have been covered, sanded & primed.



Fig 6. The floats have been painted black, decorated with stick-on plastic trim, ready for mounting.

Doping the Eze Way

Eze Dope BD42 is fast becoming the best, clean, safe way to shrink, air-proof & finish tissue covering on a model aircraft.

Its benefits are:

- No smell so can be applied indoors & thinned with soft or distilled water
- The finish is stable & non sagging in humid conditions
- The final finish can be adjusted with multiple coats
- Tools & brushes are easily cleaned with water

We paired up with **Andy Sephton** to finish his latest Pippit 21 inch wingspan cabin model design.



Deluxe Materials Ltd Eze Dope is a great safe clean way of airproofing tissue covered model aircraft. We hope this article will inspire to try out this new technique.



The ready to fly Sams Pippit looking good. Now with the small diesel power plant so all we need is a calm day!

Fig 1. Here is where we start -The new Sams Pippit kit with beautiful laser cut parts plan etc.



Fig 2. The airframe is ready for pre-shrinking. The covering tissue was bonded with Deluxe Materials **Tissue Paste** (AD60) which works with cellulose & **Eze Dope**. A 5% solution was made up (5 parts **Eze Dope** to 95 parts water). **Tip: Use soft or distilled water.**



Fig 3. This solution was brushed onto the frame with a soft head brush which seals the tissue in place.



Fig 4. The tissue after drying is now shrunk with 5% solution of **Eze Dope** & ready for easy doping.



Fig 5. Successive application of more concentrated solution (30% **Eze Dope** to 70% water) guarantees a great finish without puddling or blotchiness that can occur if used neat. Again use soft or distilled water.



Fig 6. As a diesel engine was being fitted we doped the engine bay with **Eze Dope** solution which renders the surface 100% fuel proof.



Thanks to Andy Sephton for his time, superb construction & the lovely set of instructional photos.



Fig 7. The finished model with flying surfaces – the tissue all beautifully shrunk & ready for final finishing & decoration.



Fig 8. Red & blue tissue trim ready for application. A 30% solution is nice & sticky so seals the tissue trim in place.



Roket Card Glue holds its own... & everything else too!

“By far & away the best glue I've used for card kits by Metcalfe”

Peter Marriott shows you the several techniques to use Roket Card Glue to assemble a Metcalfe Models 00 scale mini kit & also save you time.

Deluxe Materials **Roket Card Glue** is an excellent glue because it:

- is solvent free
- is non-stringy
- allows adjustment
- sticks card instantly under light pressure

Also being water soluble the glue is both safe to use & it dries clear. It will also bond paper & plastic sheet to card.



Fig 1. Here are the parts in the Metcalfe Models scale platform kiosk kit.



Fig 2. Running a bead of **Roket Card Glue** around the inner edge of the folded card. **Use less rather than more of this powerful adhesive.**



Fig 3. An alternative method: drag the edge of the tip along the edge of the card.



Fig 7. Just one small drop under this piece of cardboard fixed it quickly & firmly in place.



Fig 8. The adhesive is applied to the roof & then brushed evenly over the cardboard prior to attachment.

Tip: Have a small bowl with clean water ready to clean up excess adhesive before the glue dries. The completed model will look so much better.



Fig 9. The platform kiosk on a station platform took around an hour to make with **Roket Card Glue**.

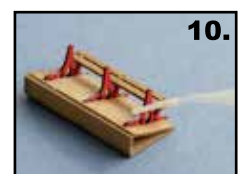

Fig 10. Next up the platform benches. With the parts in their jig only a very thin layer of **Roket Card Glue** was needed to bond the bench seat supports.

Fig 11. Two of the completed platform benches with each bench taking just five minutes to assemble.

Fig 12. How long do we wait for the next train?



Fig 4. The clean joint of the roof of the platform kiosk. Because only a minimum amount of adhesive was used the glue fixes immediately with light pressure.



Fig 5. Using the **Pin Point** bottle & its tip allows a thin layer of adhesive in the corner groove.



Fig 6. Alternatively pour out a drop of the adhesive onto cardboard then use a fine paintbrush to apply "dots" of glue.



WHICH WATER?

With Deluxe Materials
it really is **'AQUA MAGIC!'**

Peter Marriot shows you how to use our products to create realistic water effects

1. Deluxe Materials has products for all types of water situations.



Aqua Magic

Fig 6. Preparation: First create your scene – & here we have a river bed & waterfall. Make sure the wood / base is not damp & any glue is fully dry, especially if you have used pva & water to bond scatter. If in doubt try a small area with **Aqua Magic**. Coat the water cavity with a thin layer of **Aqua Magic**, allow to dry & pour on 2-3mm of **Aqua Magic** to suit. Allow to dry in a cool place for 24 -36 hours before adding layers if required.

Fig 7. **Aqua Magic** can also be tinted to create different effects...such as puddles mud... **Scenic Colours BD23** work well.



Making Waves

Fig 8. To create a waterfall effect use **'Scenic Fibres'** cut to length...

Fig 9. ... & then **Making Waves** can be brushed on to create a thin layer of flowing water. In some areas it has been applied clear & in others a touch of white has been added.

Aqua Magic water can be used to create the illusion of movement.

Fig 10. The finished diorama shows just how effective **Solid Water**, **Making Waves** & **Aqua Magic** can be.



BALLAST BOND *s in a FLASH!*

Ballast Bond by Deluxe Materials is a new way to ballast track in all scales. It is highly penetrating, dries clear & is very easy to apply & does not move the ballast.

The step by step process of using Ballast Bond AD75 goes like this:

Fig 1. Ballast Bond (100 ml) & one Rokat Glue Tip.

Fig 2. Carefully tip the ballast in between sleepers using a small spoon or a ballast spreader tool.

Fig 3. Use a soft paintbrush to spread the ballast evenly between the sleepers. The goal is that there are no stray granules of ballast left on the top or side of the rails.

Fig 4. Some types of ballast may benefit from a light misting of water and a few drops of detergent to assist penetration.



Fig 5. Ballast Bond comes with a Rokat Glue Tip ideal to get into tight areas.

Fig 6. Carefully dribble the Ballast Bond along the outside of the rails. We found Ballast Bond did not disturb any ballast & quickly spread.

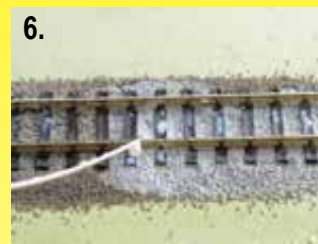

Fig 7. This picture shows saturated ballast at the top & dry at the bottom. The white colour of the Ballast Bond makes it easier to see where the ballast has adhesive & where it does not. Note the ballast has remained undisturbed while Ballast Bond was added.

Tip: use a piece of kitchen towel to soak up any excess glue.



Fig 8. A section of finished track the next day; the Ballast Bond has dried matt ready for action.

“How to make Snowy Scenery” by Frederik Astier & courtesy of Steel Masters magazine



Fig 1. The diorama base was sculpted with foam board (3 separate pieces road, roadside & marked trees).



Fig 2. Scenic Snowflakes were sprinkled over a layer of the Scenic Bond.



Fig 3. Snow mounds were created by the roadside from a snow mix of Scenic Bond & Snowflakes.



Fig 4. Melted snow created from a more diluted (tap water added) snow mix was added to the centre of the road & track prints created in the snow.



Fig 5. Before the snow dried icy sparkles were sprinkled here & there.



Fig 6. A slightly diluted dark brown wash was added to create depth in the ruts.



Fig 7. Scenic Spray was given to the trees (like rain) & Snowflakes were sprinkled over the pine tree (from Anita Decor /NL).



Fig 8. The trees were then added to the diorama.

Fig 9. The 2010 winter snow scene featuring the Leopard 2A4 tank on training exercises near the Parola garrison, Finland.



A Deluxe Bathroom

Learn how to construct & create authentic water effects to your bathroom using Plastic Magic, Roket Plastic Glue, Solid Water, Aqua Magic & Making Waves from Deluxe Materials.

By Candy Chappill/Kims



10. The finished Chrysnbon bathroom with Aqua Magic puddle!

Our thanks to Candy Chappill for this lovely piece of work.
www.candykims.co.uk



Fig 1. Use Deluxe Materials **Plastic Magic** to assemble the stool. It is ideal for close fitting joints as it acts quickly. The bathroom cabinet was assembled similarly.



Fig 2. Using **Plastic Magic AD77**, assemble the radiator. Identify & join the four centre sections first using the fine point brush for intricate joints.



Fig 3. To join the toilet bowl, use **Roket Plastic Glue** or **Plastic Magic 10 Sec Cement**. It allows a longer working time & can be spread thinly over both sides of the bowl without evaporation.



Fig 4. Use **Plastic Magic** to assemble the toilet cistern & create a nice strong bond .



Fig 5. Using **Plastic Magic**, assemble the sink, including the taps. The fine point brush is in its element here, as securing the taps can be a little fiddly.



Fig 6. Your bathroom ready for the addition of the waters. I added a small piece of Blu-Tack to the bottom of the toilet to create a seal.



Fig 7. Use **Aqua Magic** for shallow water in the toilet & sink. It can be built up in layers. It needs no mixing. I did mine in three layers.

Fig 8. For deeper water in the bath, use **Solid Water**. Measure ACCURATE volumes (2 parts resin, 1 part hardener by weight or volume), mix together well before pouring. For accuracy use digital scales pouring one part into the other.



Fig 9. To add a running water effect, use **Making Waves** & a **Pin Point Syringe** with a fine needle point. Carefully extrude some at the tap & allow to fall onto the dry **Aqua Magic**. It dries clear, & more layers & ripples can be added once dry.





SOLID WATER

"An Appetite for Colour"

HOW TO COLOUR SOLID WATER WITH PAINT

Deluxe Materials Solid Water (BD35) two part resin mix can be used to make crystal clear water effects in your dolls house. In this article Catherine Davies shows you how to colour Solid Water using paints to create a wonderful set of summertime treats!

To start, it is vital that you strictly measure two parts resin to one part hardener & mix them thoroughly until the mixture goes crystal clear. You are then ready to shape & colour.



For shaping, I recommend using a silicone mould since Solid water can be easily poured in when freshly mixed, then pushed out cleanly as a perfect shape. For this project, I have made two of my own moulds starting with Fimo clay formers.



TOFFEE

To make toffee, add a few drops of toffee coloured enamel paint to Solid Water. Mix together thoroughly until it turns opaque (like toffee!).

Pour the coloured Solid Water into your mould straight away.

Leave the mixture in the mould until it has set hard for a simple slab of toffee. For toffee pieces however, remove while it is still a little soft & cut into the desired shapes with scissors.



JELLY

Coloured Solid Water makes perfect jellies. This time, for a translucent effect, add a little spirit-based glass paint to Solid Water.

Mix together thoroughly.

Pour into a jelly mould & allow to set hard before removing it. (Note - Solid Water jellies don't wobble!)



ICE CUBES

Make your own ice-cubes from uncoloured Solid Water – & add this to your ice cube mould. Using a Pin Point syringe fitted with a needle tip to do this aids precision.

For realistic detail add a speck of "neat" white glass paint into your ice cubes, leaving some clear if you wish.

Remove the ice cubes from the mould when they are set hard.

MELTING ICE CUBES

To show what ice cubes do best when they're removed from the freezer, pile the ice cubes up together in a dish & finish by drizzling over some freshly prepared un-coloured Solid Water for melting ice (& adhesion).



DRINKS

You can make any drink you like with coloured Solid Water – cloudy or clear depending on the paint you use.

As a serving suggestion, first fill a jug with ice cubes (& maybe your own ready made fruit slices), then add freshly mixed "orange juice", allowing it to sink & settle through the ice cubes.

Or first fill the jug with "Pims" & leave until it has half set. Then push in any of your own fruit slices & top with some ice cubes to look as though they are floating/sinking. You should be able to see the detail of the ice cubes & the fruit through this translucent mix.



CREAM

No moulds or scissors are needed here, just some fresh Solid Water coloured with cream coloured enamel paint. Simply pour over your fruit, allow to settle & set.



TOP TIPS

1. Always measure Solid Water accurately. Add 1 part hardener into 2 parts Resin; by weight or volume will work. Mix them thoroughly .
2. For opaque effects, you can substitute enamel paints for glass paint if you prefer.
3. When mixing paint into Solid Water, only use the minimum amount of paint you need to get the desired effect & colour. This will ensure that the Solid Water sets properly.

*This is summer
with Solid Water*

Our thanks to Catherine Davies for her incredible work.



APPLICATION GUIDES - Rail

Download large A4 version from our website
www.deluxematerials.com

WORLD CLASS RAILWAY MODELLING PRODUCTS

deluxematerials.com



- Smoke oil with authentic odour
- Trouble free bonding diorama backscene papers
- For filling fine gaps in plastic railway kits
- Liquid weighting system for rolling stock
- For dramatic snow scenes
- For temporary holding of small figures
- For securing model railway track, street furniture, buildings & trees
- For gluing scatter & foliage
- Softens & removes paint from plastics in minutes
- Fine powder adhesive for bonding ballast & granular materials
- For easy bonding of railway ballast
- Cleans, protects track for max response & reliability
- For creating realistic diorama groundwork
- For invisible joints on ABS, styrene etc. Low odour plastic cement
- Dries tacky for bonding static grass & scatter
- For white water effects, rivers, waterfalls
- For modelling realistic water
- For making ripples & wave effects
- For crystal clear & deep water effects
- Non-runny, gap filling cyano
- Creates real rust effects with texture
- High precision, long reach brushes
- For precision glue lines
- Clean, neat, instant card modelling glue
- For gluing & creating crystal clear windows
- Cyano glue for common plastics, resin & metal
- Non-fogging grade for clear windows

Dolls house

- Roket Cyano For fast wood joints & shingle
- Decorator Glue For upholstery fabric
- Speedbond For wood bonding
- Solid Water For deep water e.g. bath, sinks
- Scenic Water For domestic liquids, jams, food etc.
- Liquid Gravity For weighting curtains, cushions etc.
- Super 'Phatic! Glue for laser cut wood
- Tacky Wax Temporary adhesive
- Wallpaper Paste
- Aqua Magic For shallow water in the bathroom
- Scatter Grip For bonding & static grass in gardens
- Glue 'n' Glaze For bonding windows
- Aliphatic Resin For wood, furniture. Takes a stain
- Sand 'n' seal For sealing wood before painting
- Scenic Shovelled & Scenic Snow Kit
- Brush Magic Cleaning brushes & wood prior to staining

Aeromodelling

Download large A4 version from our website
www.deluxematerials.com

Aeropoxy
For laminating & wing skinning

Eze-Kote
Finishing resin with glass cloth

Speed Epoxy II
For high strength joints, formers & engine mounts

Aerokote
High gloss fuel proofer e.g. fuel tank bays

R/C Modellers Canopy Glue
Clear setting

Wonderfill
High strength foam filler

Speed Epoxy II 20min
Increased working time & strength for tail plane surfaces

Super 'Phatic!
Glue for laser cut wood, hinges

Fix 'N' Flex
Fixing servos/undercarriage into foam models

Aliphatic Resin & Speedbond
For wood

Roket Cyano
For rapid wood construction

Model Lite
Balsa wood filler

Boats

Aliphatic Resin
For wood with waterproof joints

R/C Modellers Canopy Glue
For bonding clear plastic windows

Fix 'N' Flex
For re-bonding decal edges

Speed Epoxy II
For high stress areas, bonding & filleting bulkheads

Aero Tech
Epoxy non-drip for wood to GRP

Super 'Phatic!
For wood planking onto plastic deck

Wonderfill
Tough sandable wood contouring filler

Super 'Phatic!
For high stress areas / joints, rudder, motor etc.

Liquid Gravity
Ballast weight

Plastic Magic 10 Sec Cement
For plastic deck to hull joints

Sand 'n' Seal
For sealing wood before painting

Super 'Phatic!
Wooden outside stringers to plastic / GRP hull

Super 'Phatic!
1/8" strip outside hull

Fusion
For high stress areas / joints, rudder, motor etc.

Super Crylic!
For bonding & laminating wood & metal propshafts inside hulls

Mail order/on-line: Visit www.deluxematerials.com to purchase our products, access glue charts, see full worldwide distributor list & view videos & downloads to help you with your modelling experience or alternatively

Telephone: +44 (0)1529 455 034 email: sales@deluxematerials.co.uk

North American consumers visit www.deluxematerialsus.com

Visit **YouTube** to view numerous videos with useful tips and ways on how to use Deluxe Materials products

Modellers: Please support your local model shop

WE SHOW YOU HOW

We would like to thank the many skilled modellers who publish work using our products or have helped us create this catalogue by contributing articles on techniques, photographs or videos that you will find on our YouTube Channel. If you would like to help us bring a project to life, have a photograph to send us or a new product idea, do email us from our website. In the meantime we hope to have helped you with a task or simply to enjoy your chosen hobby - **John & Vivienne Bristow**

Deluxe Materials

Bob Benjamin - Master Workshop, rcmodel.com



R/C Modelling

Gary Ritchie - USA
 Bob Benjamin - USA
 Andy Rann
 Steve Schafer
 Andy Sephton
 Steve Woods
 Roy Thompson
 John Roper

Railway

Peter Marriott
 George Dent
 Len Weal
 Nick Duxfield
 Wayne Merridew
 Paul Whyte

Miniatures

Candy Chappill
 Catherine Davies
 Jenny Kelm

Scale and plastics

Jose Brito - Portugal
 Frederik Astier - France
 Nicholas Smith
 James Ashton
 Andy Argent
 Simon Hammerton
 Jezz Coleman



